

Apollo GoboPro+ LED

Outdoor Profile



Introduction

Since 1992, Apollo Design Technology, Inc. has been one of the world's leading innovators, manufacturers and distributors of gobos, color filters, lights and related equipment and accessories for the lighting industry.

We are continually engineering new products to help you create and execute the designs of your dreams for theaters, bands, advertising, touring companies, television, motion pictures, museums, retail and architecture.

Apollo Design is recognized for creating innovative and award-winning products of superior quality and value. Focused on you, our goal is to ensure unparalleled support from the initial conversation to after sales service.

Our lighting experts and engineers will consult with you on ways to use our standard products or engineer custom solutions. Allow your imagination to run free. Let the Apollo Design team help you create the lighting design you only imagined.

There is virtually no limit to what we can do together.



Joel Nichols, Owner/CEO
Apollo Design Technology

Product Description

Congratulations on the purchase of your Apollo GoboPro+ LED Outdoor Profile. This fixture projects static or rotating gobo patterns with high output and fantastic optical clarity.

Apollo Design is proud to be the exclusive USA distributor.

Table Of Contents

Safety Instructions.....	2
Installation	
Mounting.....	3
Waterproof Barrel.....	3
Lens Fitting & Focusing.....	4
Distance Calculation Formula.....	5
Operation	
Gobo & Gobo holder.....	5
Attaching the complete gobo holder to fixture.....	5
Removing the complete gobo holder from the fixture.....	6
Inserting a gobo into the gobo holder.....	6
Removing the gobo from the gobo holder.....	6
Controlling the image.....	7
Specifications	8
Warranty	9

BOX CONTENTS

- 1 - Apollo GoboPro+ LED Outdoor Profile fixture
- 1 - User Manual
- 1 - Allen Wrench
- 1 - PSU Power Supply
- 1 - Gobo Cassette



Safety Instructions

1. Read and understand all instructions before using the equipment.
2. Close supervision is necessary when any fixture is used by, or near, children.
3. Care must be taken, as burns can occur from touching hot parts.
4. Do not operate fixture with a damaged cord, or if the fixture has been dropped, or damaged, until it has been examined by a qualified engineer.
5. Position the cord so that it will not be tripped over, pulled, or come into contact with hot surfaces.
6. If an extension cord is necessary, a cord with a current rating at least equal to that of the fixture should be used. Cords rated for less amperage than the fixture may overheat.
7. Always unplug fixture from electrical outlet before cleaning and servicing and when not in use. Never yank cord to pull plug from outlet. Grasp plug and pull to disconnect.
8. Let fixture cool completely before packing. Loop cord loosely around fixture when storing.
9. To reduce risk of electric shock, do not immerse product in water or other liquids.
10. To reduce the risk of electric shock, do not dismantle this fixture.
11. Do not attempt to service the fixture unless you are qualified and working under the direction of the manufacturer.
12. The use of an accessory attachment not recommended by the manufacturer may cause a risk of fire, electric shock, or personal injury.
13. A safety chain or cable must be fitted to the fixture and secured to an immovable object where applicable. The securing point must be able to withstand the shock weight of the fixture should it fall.
14. After any maintenance or cleaning all parts must be absolutely dry before refitting to the fixture.
15. During focusing of the projected image beware of moving the lens too far, as this may cause the lens to become separated from the fixture, and perhaps drop and break causing injury.
16. Flammable surfaces should be 2 feet away from the front of the fixture.

Mounting

Apollo GoboPro+ LED Outdoor Profile is supplied with one u-shaped bracket that can be mounted to any immovable surface. The mounting bracket opening is 0.43"(11mm). The angle of the u-shaped bracket can be adjusted using the pivot handles on the side of the fixture. It is recommended that the power cable is installed at the top of the fixture in wet conditions to reduce the risk of water ingress into the body. If the fixture is to be mounted vertically downwards, it is recommended a small disk is installed above the fixture to prevent water pooling in the back of the unit.

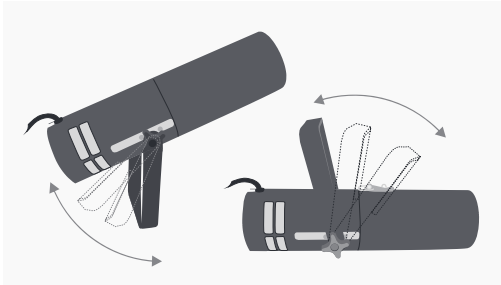

Waterproof Barrel

Apollo GoboPro+ LED Outdoor Profile is supplied with one 7.87"(200mm) long IP-rated 65 barrel (suitable for 18°(120mm) lens). To remove the barrel, gently wiggle the barrel and pull the barrel off. To reattach, gently wiggle and push the barrel onto the fixture. Please note that there will be a different size barrel available to accommodate 15°(150mm) lens and larger. There is a .03"(1mm) opening at the front of the barrel to drain condensation. This opening should be aligned at the bottom of the fixture. To secure the barrel to the fixture, affix the two supplied M4 x 12mm CSK stainless steel screws through the openings in the mounting bracket.

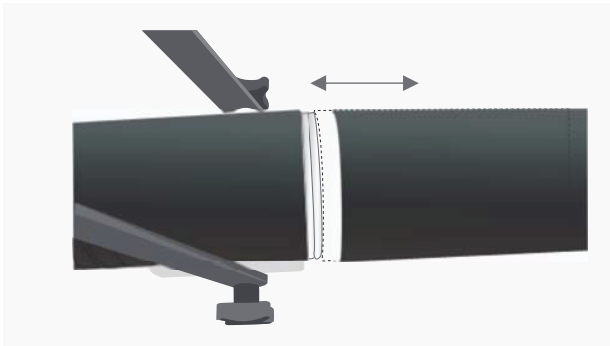

Lens Fitting & Focusing

To change the lens, loosen the screw on the bottom of the lens housing and remove. Insert the new lens to a balanced position and tighten the screw on the bottom of the lens housing. To project a focused image, it is necessary to finely adjust the focusing lens after the unit has been pointed at the desired projection surface. To adjust the focusing lens, loosen the screw on the side of the lens housing and slide the housing along the rails until the image is focused. Secure the lens housing to the rails by tightening the screw on the side.



Distance Calculation Formula

$$\frac{\text{Lens Focal}}{\text{Object Size}} \times \frac{\text{Projection Distance}}{\text{Image Size}}$$

Lens Degree	Projection Distance to Image Size(ratio)	Lens Focal Length
52°	1:1	45mm
36°	3:2	60mm
26°	2:1	85mm
18°	3:1	120mm
15°	4:1	150mm

Gobo & Gobo holder

Apollo GoboPro+ LED Outdoor Profile fixtures accommodate an outside diameter of 50mm (+0 -0.1mm) rotatable gobo, and a 44mm OD (+0 -0.1mm) static gobo which can be purchased from Apollo directly. A 50mm gobo holder is supplied with every GoboPro+ into which all gobos need to be inserted for projection.

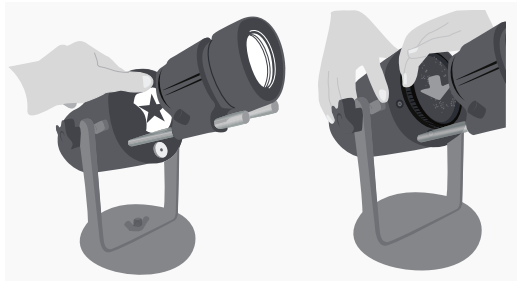

Attaching the complete gobo to the fixture

Engage the gobo holder onto the drive gear at the bottom and gently snap the gobo holder onto the fixture.

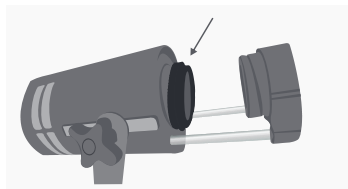

Removing the complete gobo from the fixture

Insert a fingernail or flat blade screwdriver into the gap between the gobo holder and the fixture and gently lift out the gobo holder. Additional gobo holders are available from Apollo.

Inserting a gobo into the gobo holder

Line up the gobo with one of the tabs on the gobo holder and gently press the gobo using your thumbs level with the two other tabs. When the gobo is fully inserted, you will hear a click noise. If inserting a 44mm static gobo, turn the gobo holder over and gently push the gobo into the back of gobo holder. It is recommended that the two image faces of the 44mm and 50mm gobo are placed toward each other. It is recommended to use a separate gobo holder for each gobo.

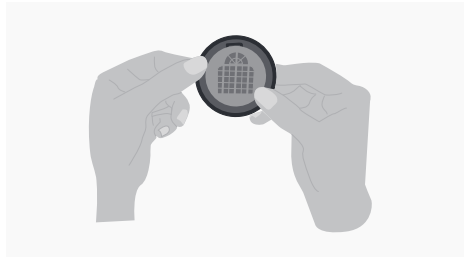

Removing the gobo from the gobo holder

Wait until it is cool enough to touch before attempting to remove the gobo from the gobo holder. It is easier to remove the gobo from the gobo holder if it is slightly warm. To remove the static 44mm gobo firmly tap the gobo holder onto a hard surface. To remove the rotating 50mm gobo, gently press the gobo out with your thumbs from the rear.

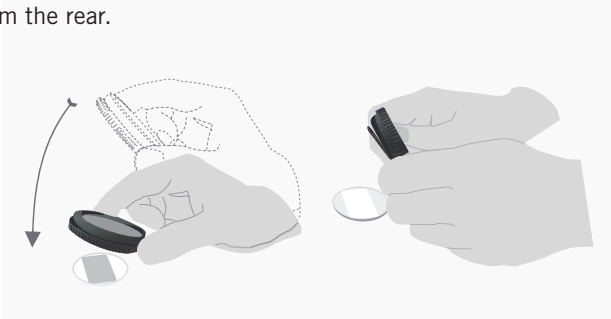

Controlling the image

The Apollo GoboPro+ LED Outdoor Profile has an internal variable speed rotator. The 50mm gobos can project static and/or rotating images. To rotate the image clockwise engage the toggle switch upwards. To rotate the image counter clockwise, engage the toggle switch downwards. For a static image, make sure the toggle switch is in the central position. To control the speed of the rotation use the black adjustment knob. To increase the speed, turn the black knob clockwise. To slow the speed of the rotation, turn the black knob counter clockwise.

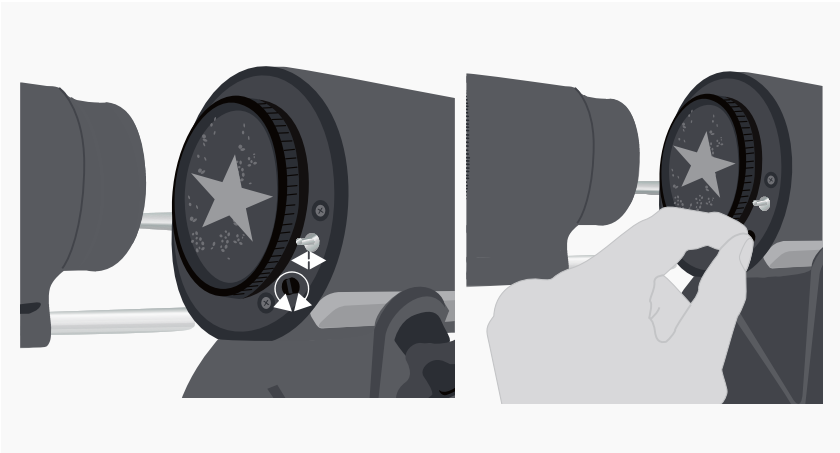

Specifications

TECHNICAL SPECIFICATIONS	
Name	Apollo GoboPro+ LED Outdoor Profile
Gobo Projection	Static and/or rotating image. Integral rotator for gobo movement
Lens Options	52°(45mm), 36°(60mm), 26°(85mm), 18°(120mm), 15°**(150mm), 26°-12°** (zoom)
Focus	Manual
Light Source	75W LED
Lumens	2,800
Brightness	3560 Lux at 1 m Diameter
Color temperature (Kelvin)	5,600K
Color of fixture	Black, (White upon request)
Gobo Size	50mm o/d rotating, 44mm o/d fixed. (42 image diameter). Or 35mm transparency with adapter (for occasional use).
Control	Manual
Fixture Rating	IP 65 with front barrel installed. Suitable for outdoor use.
Dimension of projector	13.4"L x 9.8"H x 5.5"W x 3.9" (340mm L x 250mm H x 140mm W x 100mm)
Weight	3.5lbs (1.6kg)

*Lens sold separate

**Requires Hood Long Barrel



Warranty

- Items are covered for defects in materials and workmanship for one year, including repair parts and repair labor on defective item, from date of the manufacturer invoice.
- The warranty covers ground freight for 30 days after initial purchase.
- The manufacturer does not cover any other loss resulting from product failure.
- Products being returned for warranty repair must display the original serial number. Removal of the serial number voids the product's limited warranty.
- Despite the care taken for the compilation of this manual, Apollo Design Technology, Inc. cannot be held responsible for any damages resulting from errors that may appear in this manual. All efforts have been made to provide the most accurate, up-to-date instructions and illustrations possible.

Serial Number	
Date Purchased	
Purchased From	





Apollo GoboPro+ LED

Outdoor Profile



Apollo Design Technology, Inc.
260.497.9191
ApolloDesign.net